

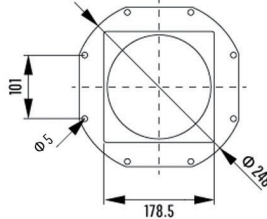

Engineering Drawing (mm)

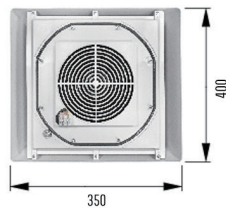

Characteristics of static pressure

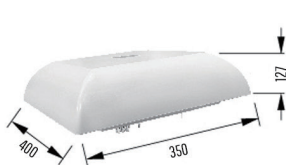
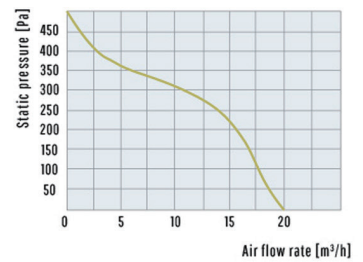

Specifications

Model No. (Cabinet Roof Fan)	G2E190-230-DH	G2E220-230-DH	G2E225-230-DH
Rated operating voltage	230V	230V	230V
Frequency	50/60 Hz	50/60 Hz	50/60 Hz
Air flow rate (Free blow)	570/620 m³/h	860/900 m³/h	1200/1340 m³/h
Air flow rate with filter	1 x GF6626.300:456/496 m³/h	1 x GF6626.300:540/688 m³/h	1 x GF6626.300:960/1072 m³/h
Max. rated current	0.34/0.26A	0.40/0.38A	0.88/0.60A
Rated Power	75/58W	90/85W	200/135W
Noise level	62/64 dB(A)	73/74 dB(A)	69/71 dB(A)
Operating temperature range		-10°C ~ 60°C	